

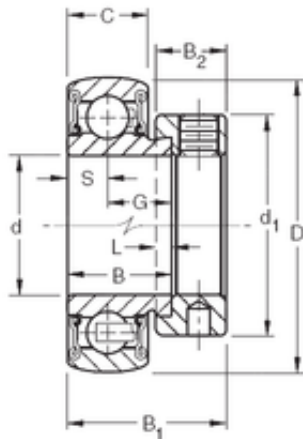

Bearing industry co., Ltd.

35 mm x 72 mm x 25,4 mm TIMKEN RAE35RRB Insert Bearings Spherical OD



Bearing No. RAE35RRB

Size	35x72x25.4 mm
Bore Diameter	35 mm
Outer Diameter	72 mm
Width	25,4 mm
d	35 mm
D	72 mm
B	25,4 mm
C	19 mm
d1	54,4 mm
B1	38,9 mm
B2	17,1 mm
G	15,9 mm
L	4 mm
S	9,5 mm
Weight	0,513 Kg
Basic dynamic load rating (C)	28,5 kN

RAE35RRB Bearing 2D drawings and 3D CAD models